

**Delta-P Ltd**

Connect with Confidence

# **Pneumatic Quick Release Couplings**

## **Product Catalogue**

**Delta-P Ltd**

Connect with Confidence

At Delta-P we're pleased to offer a comprehensive range of market-leading, high quality, reliable and cost effective quick connect couplers to meet the needs of maintenance/repair operations (MRO), re-sellers, end users and original equipment manufacturers (OEM).

Our team of experts have a wealth of experience in the quick coupling industry and are on hand to provide support and advice.

At Delta-P we'll continually strive to review our customer requirements across the entire product range, and aim to react rapidly and efficiently in response to customer needs whilst increasing our range of pneumatic and hydraulic solutions.

### Pneumatic Couplings

Delta-P Ltd offers six different styles of pneumatic couplers and plugs all of which are currently in use within automotive and industrial applications today. Originally developed by different manufacturers some couplers provide greater flow capabilities than others, although there's no direct advantage of one style over another (provided they are quality made).

Delta-P offers interchanges with couplers and plugs that will work with most other manufacturer's versions of the same profiles. It is vital that the correct series is chosen as couplers and plugs with the same profile from different manufacturers will connect, however, a coupler and plug from a different series will not.

Please see below our profile identifier.

P19 - UK Standard



P300 - Aro 210 Standard

P310 - ISO 6150B Standard  
- 5.3 mm diameter

P320 - European Standard

P430 - ISO 6150B Standard  
- 8.2mm diameterP500 - ISO 6150B Standard  
- 11mm diameter

## Pneumatic Quick Release Couplings

### P19 Series - UK Standard



### Features

- Standard: UK (PCL) Standard
- Sizes 1/4" - 3/8 - 1/2" and Barb
- Nominal flow diameter: 4.8mm
- Carbon steel
- NBR sealing
- Working Pressure: 1 Mpa
- Corrosion resistant plating- CR3
- Pneumatic tools, air compressors, measuring and control equipment
- Interchange: PCL AC standard, Cejn 295, Rectus 19KA

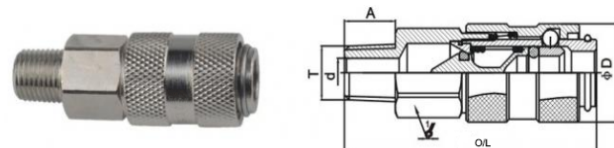

Part No.	O/L	D	Hex 1	A	T	d
P19-F-04GM	64.5	23.3	19	13	1/4	7
P19-F-06GM	63	23.3	19	13	3/8	11
P19-F-08GM	60.5	23.3	22	14	1/2	14

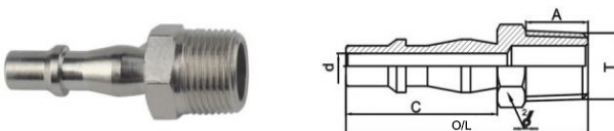

Part No.	O/L	C	Hex 1	A	T	d
P19-M-04GM	50.5	31.5	14	13	1/4	4.8
P19-M-06GM	51	31.5	17	13	3/8	4.8
P19-M-08GM	52	31.5	19	13	1/2	4.8

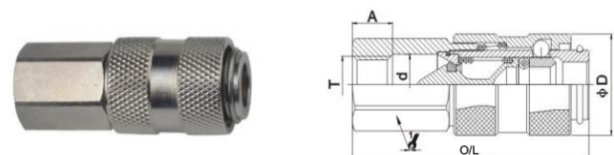

Part No.	O/L	D	Hex 1	A	T	d
P19-F-04GF	58.5	23.3	19	10	1/4	14
P19-F-06GF	57.5	23.3	19	10	3/8	14
P19-F-08GF	60.5	23.3	24	12	1/2	14

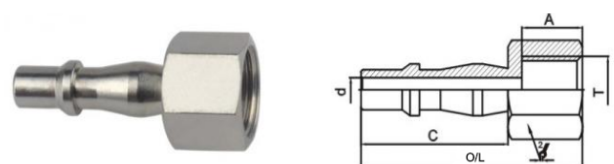

Part No.	O/L	C	Hex 1	A	T	d
P19-M-04GF	47.5	31.5	17	13	1/4	4.8
P19-M-06GF	47.5	31.5	19	13	3/8	4.8
P19-M-08GF	47.5	31.5	24	13	1/2	4.8

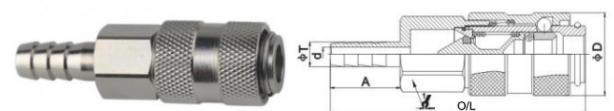

Part No.	O/L	D	Hex 1	A	T	d
P19-F-07B	73	23.3	19	20	7	4
P19-F-09B	76.5	23.3	19	25	9	5
P19-F-11B	76.5	23.3	19	25	11	7.5

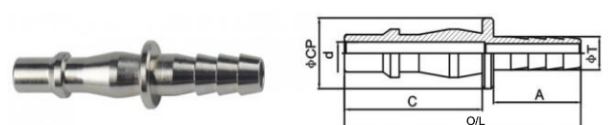

Part No.	O/L	C	Hex 1	A	T	d
P19-M-07B	54	31.5	15	20	7	4.8
P19-M-09B	59	31.5	15	25	9	4.8
P19-M-11B	59	31.5	15	25	11	4.8

## Pneumatic Quick Release Couplings

### P300 Series - Aro 210 Standard



### Features

- Standard: Aro 210
- Sizes 1/4" - 3/8" and Barb
- Nominal flow diameter: 5.5mm
- Working pressure: 1.6 Mpa
- Carbon steel
- NBR sealing
- Corrosion resistant plating- CR3
- Pneumatic tools, air compressors, measuring and control equipment
- Interchange: Parker 50, Rectus 22KA, Cejn 300

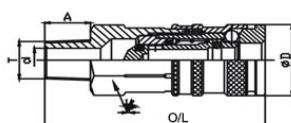

Part No.	O/L	D	Hex 1	A	T	d
P300-F-04GM	63.2	23.3	20	13	1/4	7.8
P300-F-06GM	61.2	23.3	20	13	3/8	11.3

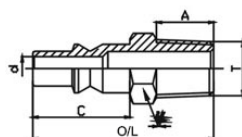

Part No.	O/L	C	Hex 1	A	T	d
P300-M-04GM	43	24	14	13	1/4	5.2
P300-M-06GM	43.5	24	17	13	3/8	5.2

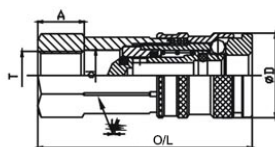

Part No.	O/L	D	Hex 1	A	T	d
P300-F-04GF	60.2	23.3	20	13	1/4	14
P300-F-06GF	60.2	23.3	22	12	3/8	14

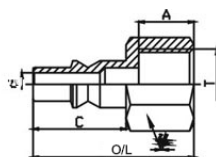

Part No.	O/L	C	Hex 1	A	T	d
P300-M-04GF	40	24	17	13	1/4	5.2
P300-M-06GF	40	24	19	13	3/8	5.2

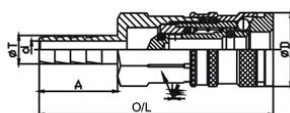

Part No.	O/L	D	Hex 1	A	T	d
P300-F-07B	70.2	23.3	20	20	7	4
P300-F-09B	75.2	23.3	20	25	9	5.5
P300-F-11B	75.2	23.3	20	25	11	7.5

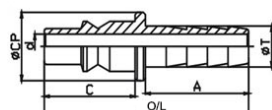

Part No.	O/L	C	Hex 1	A	T	d
P300-M-07B	46.5	24	15	20	7	4
P300-M-09B	51.5	24	15	25	9	5.5
P300-M-11B	51.5	24	15	25	11	7.5

## Pneumatic Quick Release Couplings

### P310 Series - ISO 6150B Standard



### Features

- Standard: ISO 6150B
- Sizes 1/4" - 3/8" and Barb
- Nominal flow diameter: 5.3mm
- Working pressure: 1.6 Mpa
- Carbon steel
- NBR sealing
- Corrosion resistant - CR3
- Interchange: Parker 20, Rectus 23KA, Hansen 3000, Cejn 310

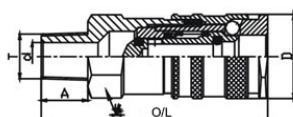

Part No.	O/L	D	Hex 1	A	T	d
P310-F-04GM	63.2	23.3	20	13	1/4	7.8
P310-F-04GM	61.2	23.3	20	13	3/8	11.3

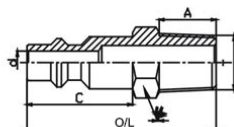

Part No.	O/L	C	Hex 1	A	T	d
P310-M-04GM	43	24	14	13	1/4	5.2
P310-M-04GM	43.5	24	17	13	3/8	5.2

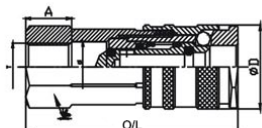

Part No.	O/L	D	Hex 1	A	T	d
P310-F-04GF	60.2	23.3	20	13	1/4	14
P310-F-04GF	60.2	23.3	20	12	3/8	14

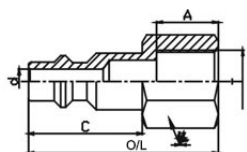

Part No.	O/L	C	Hex 1	A	T	d
P310-M-04GF	40	24	17	13	1/4	5.2
P310-M-04GF	40	24	19	13	3/8	5.2

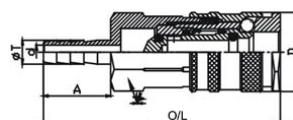

Part No.	O/L	D	Hex 1	A	T	d
P310-F-07B	70.2	23.3	20	20	7	4
P310-F-09B	75.2	23.3	20	25	9	5.5
P310-F-11B	75.2	23.3	20	25	11	7.5

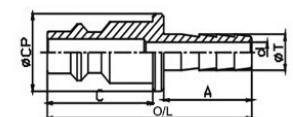

Part No.	O/L	C	Hex 1	A	T	d
P310-M-07B	46.5	24	15	20	7	4
P310-M-09B	51.5	24	15	25	9	5.5
P310-M-11B	51.5	24	15	25	11	7.5



## Pneumatic Quick Release Couplings

### P320 Series - European Standard



### Features

- Standard: European Standard
- Sizes 1/4" - 3/8"
- Nominal flow diameter: 7.6mm
- Working pressure: 1.6 Mpa
- Carbon steel
- NBR sealing
- Corrosion resistant - CR3
- Interchange: Cejn 320, Rectus 25KA and 26KA

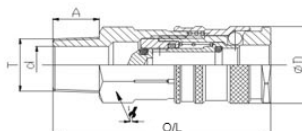

Part No.	O/L	D	Hex 1	A	T	d
P320-F-04GM	63.2	23.3	20	13	1/4	7.8
P320-F-06GM	61.2	23.3	20	13	3/8	11.3

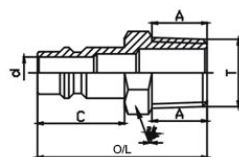

Part No.	O/L	C	Hex 2	A	T	d
P320-M-04GM	39.5	20.5	17	13	1/4	7.5
P320-M-06GM	40.5	22	14	125	3/8	7.5

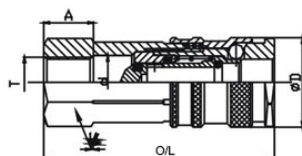

Part No.	O/L	D	Hex 1	A	T	d
P320-F-04GF	60.2	23.3	20	13	1/4	14
P320-F-06GF	60.2	23.3	22	12	3/8	14

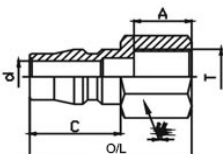

Part No.	O/L	C	Hex 1	A	T	d
P320-M-04GF	36.5	20.5	17	13	1/4	7.5
P320-M-06GF	36.5	20.5	19	13	3/8	7.5

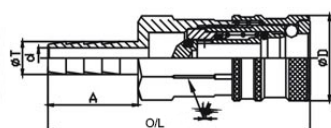

Part No.	O/L	D	Hex 1	A	T	d
P320-F-07B	67.7	23.3	20	20	7	4
P320-F-09B	72.7	23.3	20	25	9	5.5
P320-F-11B	72.7	23.3	20	25	11	7.5

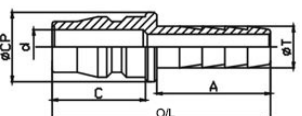

Part No.	O/L	C	Hex 1	A	T	d
P320-M-07B	43	20.5	15	20	7	7.5
P320-M-09B	48	20.5	15	25	9	7.5
P320-M-11B	48	20.5	15	25	11	7.5

## Pneumatic Quick Release Couplings

### P430 Series ISO 6150B & A-A 59439 8.2 mm

#### Features

- Standard: ISO 6150B
- Sizes 3/8" & 1/2"
- Nominal flow diameter: 8.2mm
- Carbon steel
- Working pressure: 1.6 Mpa
- NBR sealing
- Corrosion resistant - CR3
- Interchange: Cejn 430

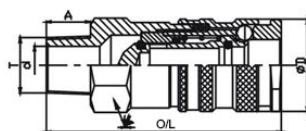

Part No.	O/L	D	Hex 1	A	T	d
P430-F-04GM	69.3	27.2	24	13	3/8	11.3
P430-F-06GM	69.8	27.2	24	16	1/2	11.3

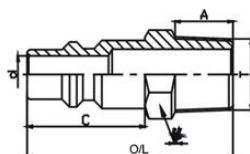

Part No.	O/L	C	Hex 1	A	T	d
P430-M-04GM	46	26.3	17	13	1/4	8.2
P430-M-06GM	51	26.3	22	16	3/8	8.2

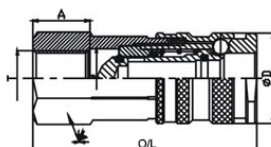

Part No.	O/L	D	Hex 1	A	T	d
P430-F-04GF	67.3	27.2	24	17.1	3/8	14
P430-F-06GF	68.3	27.2	27	16	1/2	17.9

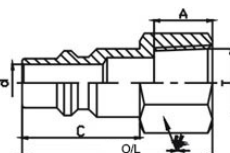

Part No.	O/L	C	Hex 1	A	T	d
P430-M-04GF	42.5	26.3	19	13	1/4	8.2
P430-M-06GF	47	26.3	27	16	3/8	8.2

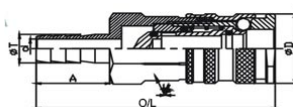

Part No.	O/L	D	Hex 1	A	T	d
P430-F-07B	81.3	27.2	24	25	11	7.5
P430-F-09B	86.3	27.2	24	30	15	10

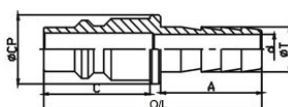

Part No.	O/L	C	Hex 1	A	T	d
P430-M-07B	54	26.3	17	25	11	7.5
P430-M-09B	59	26.3	17	30	15	10

## Pneumatic Quick Release Couplings

### P550 Series ISO 6150B & A-A-59439 11 mm

### Features



- Standard: ISO 6150B - High Flow
- Sizes 1/2" & 3/4"
- Nominal flow diameter: 11 mm
- Carbon Steel
- NBR sealing
- Corrosion resistant - CR3
- Working pressure 1.6 Mpa
- Interchange: Cejn 550

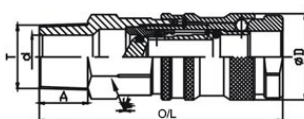

Part No.	O/L	D	Hex 1	A	T	d
P550-F-04GM	79.9	28.1	24	16	1/2	14
P550-F-06GM	81.8	28.1	27	18	3/4	18

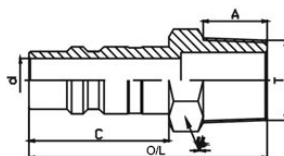

Part No.	O/L	C	Hex 1	A	T	d
P550-M-04GM	59.5	35	22	16	1/2	11
P550-M-06GM	63	35	27	18	3/4	18

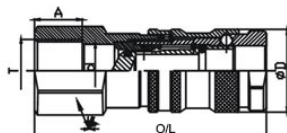

Part No.	O/L	D	Hex 1	A	T	d
P550-F-04GF	78.3	28.1	27	16	1/2	17.9
P550-F-06GF	79.8	28.1	32	18	3/4	17.9

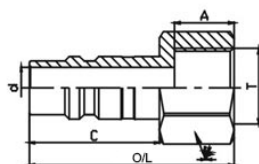

Part No.	O/L	C	Hex 1	A	T	d
P550-M-04GF	55	35	27	16	1/2	11
P550-M-06GF	57	35	32	18	3/4	11

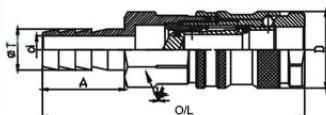

Part No.	O/L	D	Hex 1	A	T	d
P550-F-10B	96.3	28.1	24	30	15	10
P550-F-15B	96.3	28.1	24	30	20.5	15

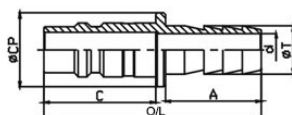

Part No.	O/L	C	Hex 1	A	T	d
P550-M-10B	68	35	23	30	15	10
P550-M-15B	68	35	23	30	20.3	15



## Brass Pneumatic Quick Release Couplings

### PB300 Series - Aro 210 Standard



### Features

- Standard: Aro 210 Standard
- Sizes 1/4" - 3/8" and Barb
- Nominal flow diameter: 5.5 mm
- Brass
- NBR sealing
- Working pressure 1.0 Mpa
- Interchange: Parker 50 Series, Rectus 22KA Cejn 300 Series

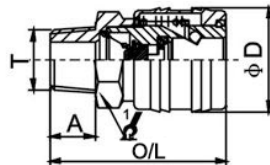

Part No.	O/L	D	Hex 1	A	T
PB300-F-04GM	46	46.8	22	11.5	1/4
PB300-F-06GM	46	46.8	22	12.5	3/8

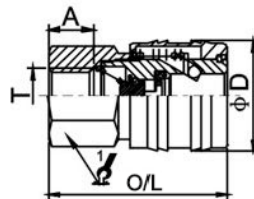

Part No.	O/L	C	Hex 1	A	T
PB300-F-04GF	43.5	26.8	22	11	1/4
PB300-F-06GF	45.5	26.8	22	11	3/8

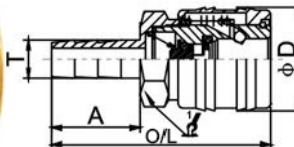

Part No.	O/L	D	Hex 1	A	T
PB300-F-07B	57.5	26.8	22	25	7
PB300-F-09B	57.5	26.8	22	25	9

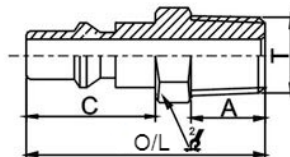

Part No.	O/L	C	Hex 2	A	T
PB300-M-04GM	40.5	22	14	11.5	1/4
PB300-M-06GM	40.5	22	14	12.5	3/8

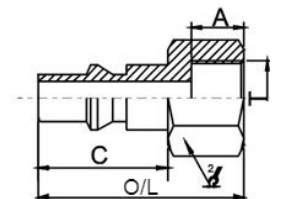

Part No.	O/L	D	Hex 2	A	T
PB300-M-04GF	35	22	17	9	1/4
PB300-M-06GF	36	22	19	11	3/8

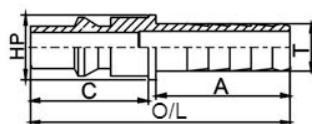

Part No.	O/L	C	O/D	A	T
PB300-M-07B	48.5	22	12	25	7
PB300-M-09B	48.5	22	12	25	9

## Brass Pneumatic Quick Release Couplings

### PB310 Series - ISO 6150B Standard - 5.3mm

### Features

- Sizes 1/4" - 1/2" & 9mm, 10.5mm, 13.5mm Barbs
- Nominal flow diameter: 5.3mm
- Working pressure: 1.0 Mpa
- Brass
- NBR Sealing
- Interchange: Parker 20, Rectus 23KA, Cejn 310 Series and Hanson 3000 Series

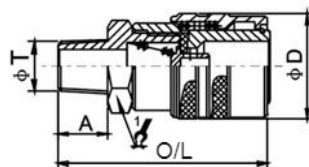

Part No.	O/L	D	Hex 1	A	T
PB310-F-04GM	51	25	19	12	1/4
PB310-F-06GM	51	25	19	13	3/8
PB310-F-08GM	53	25	22	14	1/2

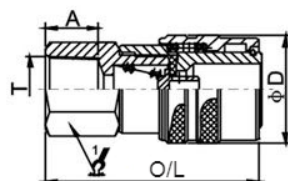

Part No.	O/L	C	Hex 1	A	T
PB310-F-04GF	49.5	25	19	12	1/4
PB310-F-06GF	49.5	25	19	12	3/8
PB310-F-08GF	49.5	25	24	15	1/2

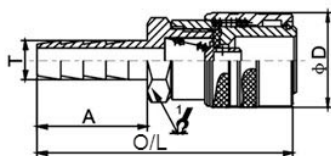

Part No.	O/L	D	Hex 1	A	T
PB310-F-09B	66	25	19	28	9
PB310-F-11B	68	25	19	30	10.5
PB310-F-13B	68	25	19	30	13

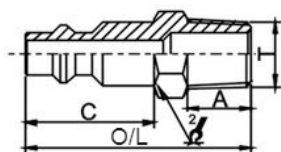

Part No.	O/L	C	Hex 2	A	T
PB310-M-04GM	42	24	14	13	1/4
PB310-M-06GM	42	24	17	13	3/8
PB310-M-08GM	44	24	22	13	1/2

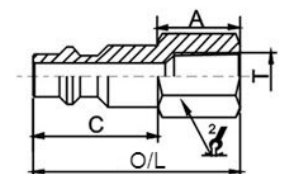

Part No.	O/L	D	Hex 2	A	T
PB310-M-04GF	39	24	17	12	1/4
PB310-M-06GF	40	24	19	13	3/8
PB310-M-08GF	44	24	24	16	1/2

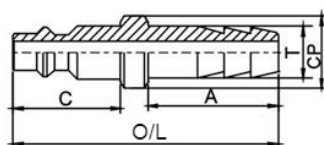

Part No.	O/L	C	O/D	A	T
PB310-M-07B	59	24	14	30	9
PB310-M-07B	59	24	14	30	10.5
PB310-M-09B	59	24	14	30	13

## Brass Pneumatic Quick Release Couplings

### PB320 Series - ISO 6150B Standard - 7.6mm



### Features

- Sizes 1/4" - 1/2" & 7.5mm-14.5mm Barb
- Nominal flow diameter: 7.3mm
- Working pressure: 1.6 Mpa
- Brass
- Interchange: Rectus 25KA & 26KA Series  
Cejn 320 Series

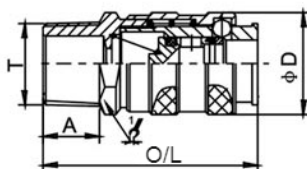

Part No.	O/L	D	Hex 1	A	T
PB320-F-04GM	52.5	25	22	13	1/4
PB320-F-06GM	52.5	25	22	13	3/8
PB320-F-08GM	54.4	25	22	14	1/2

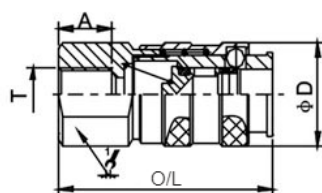

Part No.	O/L	C	Hex 1	A	T
PB320-F-04GF	52.5	25	22	13	1/4
PB320-F-06GF	52.5	25	22	13	3/8
PB320-F-08GF	52.5	25	24	14	1/2

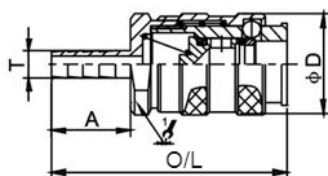

Part No.	O/L	D	Hex 1	A	T
PB320-F-09B	64.5	25	22	25	9
PB320-F-11B	69.5	25	22	30	10.5
PB320-F-13B	69.5	25	22	30	13

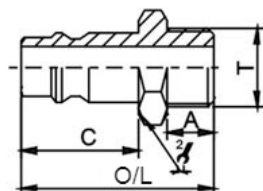

Part No.	O/L	C	Hex 2	A	T
PB320-M-04GM	40	21	14	13	1/4
PB320-M-06GM	40	21	17	13	3/8
PB320-M-08GM	40	21	22	14	1/2

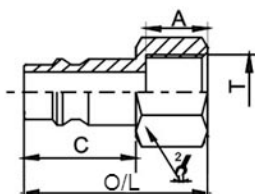

Part No.	O/L	D	Hex 2	A	T
PB320-M-04GF	37	21	17	13	1/4
PB320-M-06GF	38	21	19	13	3/8
PB320-M-08GF	38	21	24	14	1/2

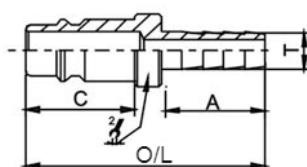

Part No.	O/L	C	O/D	A	T
PB320-M-07B	51	21	14	25	9
PB320-M-07B	56	21	14	30	10.5
PB320-M-09B	56	21	14	30	13



## Pneumatic Quick Release Couplings

### PBH320 - European Standard



### Features

- Sizes 1/4" - 3/8" & 7mm - 9mm Barb
- Nominal flow diameter: 5.5mm
- Brass
- Working Pressure: 1.0 Mpa
- Interchange: Parker 50 Series, Rectus 22KA Cejn 300 Series

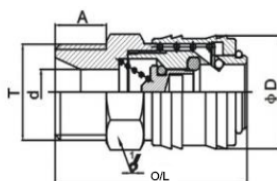

Part No.	O/L	D	Hex 1	A	T	d
PBH320-F-04GM	42	24.8	22	9	1/4	7.8
PBH320-F-06GM	42	24.8	22	9	3/8	10
PBH320-F-08GM	42	24.8	22	12	1/2	10

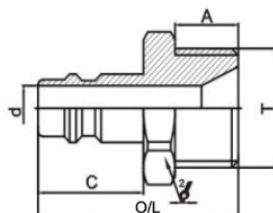

Part No.	O/L	C	Hex 1	A	T	d
PBH320-M-04GM	33	20	17	9	1/4	7.8
PBH320-M-06GM	33	20	19	9	3/8	7.8
PBH320-M-08GM	33	20	24	12	1/2	7.8

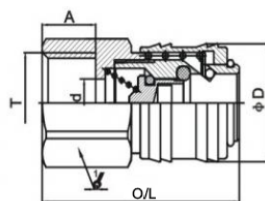

Part No.	O/L	D	Hex 1	A	T	d
PBH320-F-04GF	41.2	24.8	22	10	1/4	10
PBH320-F-06GF	41.2	24.8	22	10	3/8	10
PBH320-F-08GF	41.2	24.8	24	12	1/2	10

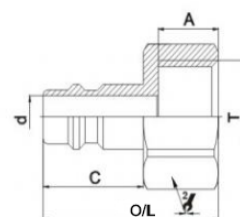
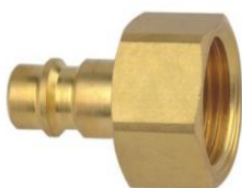

Part No.	O/L	C	Hex 1	A	T	d
PBH320-M-04GF	33	20	17	9	1/4	7.8
PBH320-M-06GF	32	20	19	9	3/8	7.8
PBH320-M-08GF	35	20	24	12	1/2	7.8

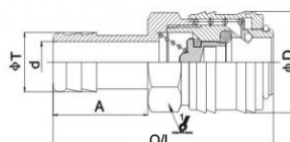

Part No.	O/L	D	Hex 1	A	T	d
PBH320-F-10B	58	24.8	21	25	7.5	4
PBH320-F-10B	58	24.8	21	25	9.5	6
PBH320-F-10B	58	24.8	21	25	11.5	7.8
PBH320-F-15B	58	24.8	21	25	14.5	10

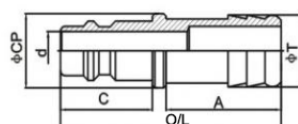

Part No.	O/L	C	Hex 1	A	T	d
PBH320-M-10B	48	20	12	25	7.5	7.8
PBH320-M-10B	48	20	12	25	9.5	7.8
PBH320-M-10B	48	20	12	25	11.5	7.8
PBH320-M-15B	48	20	12	25	14.5	7.8

## Pneumatic Quick Release Couplings

### Part Coding System

		0		1		2		3		4		5		6
Format	Series			Gender		Thread Size		Thread Form		Thread Gender		Thread Other		Seal
Example	P	320	-	M	-	06		G		M		BH x 32		V

### Explanation

#### 0 Type

P19	UK Standard Coupling	PBH320	European Standard – Brass – 1.6 Mpa
P300	Aro 210 Standard	PB320	European Standard – Brass – 1.0 Mpa
P310	ISO 6150B Standard – 5.3mm diameter	PMM	Parker MouldMate Interchange - Brass
P320	European Standard	PV	Medical Coupling -
P430	ISO 6150B Standard – 8.2mm diameter		
P550	ISO 6150B Standard – 11mm diameter		
PB300	Aro 210 Standard - Brass		
PB310	ISO 6150B Standard – 5.3mm diameter - Brass		

1 **Coupling Gender** M = Male: F = Female

2 **Thread/Barb Size** All imperial thread sizes are based on the dash systems as follows:

Thread Size		Barb Size	
-02 = 1/8"	7	10.5	13
-04 = 1/4"	7.5	11	13.5
-06 = 3/8"	9	11.5	14
-08 = 1/2"	9.5	12	14.5
-12 = 3/4"	10	12.5	

3 **Thread Form** GF = BSPP: GM = BSPT: N = NPTF:  
Blank if the termination is Barbed

4 **Barb** B = Barb

5 **Thread Other** Any other information necessary i.e. BH x 32 = Bulkhead 32mm long.

6 **Seal** This is for 'O' ring material as follows:  
If this column is Blank, then seal material is Nitrile.  
V = Viton: E = EPDM: S = Fluorosilicone: K = Kalrez: NE = Neoprene



